

The Brambles, Woodville, DE11 7FB
Offers Over £280,000
Council Tax Band: C



Positioned on a desirable modern development in Woodville, this immaculately presented three-bedroom detached home offers spacious and versatile accommodation across two floors. The property is finished to a high standard throughout, although it is in need of some minor improvements. The property includes a sleek open plan kitchen/diner, generous lounge with garden access, three well-proportioned bedrooms, and two contemporary bathrooms. The home also benefits from an enclosed rear garden, a private driveway, and an integral garage.

Situated close to a wide range of local amenities, excellent transport links, schools, and beautiful countryside walks, this is an ideal family home in a popular location.



Open House Burton & Swadlincote

The Brambles

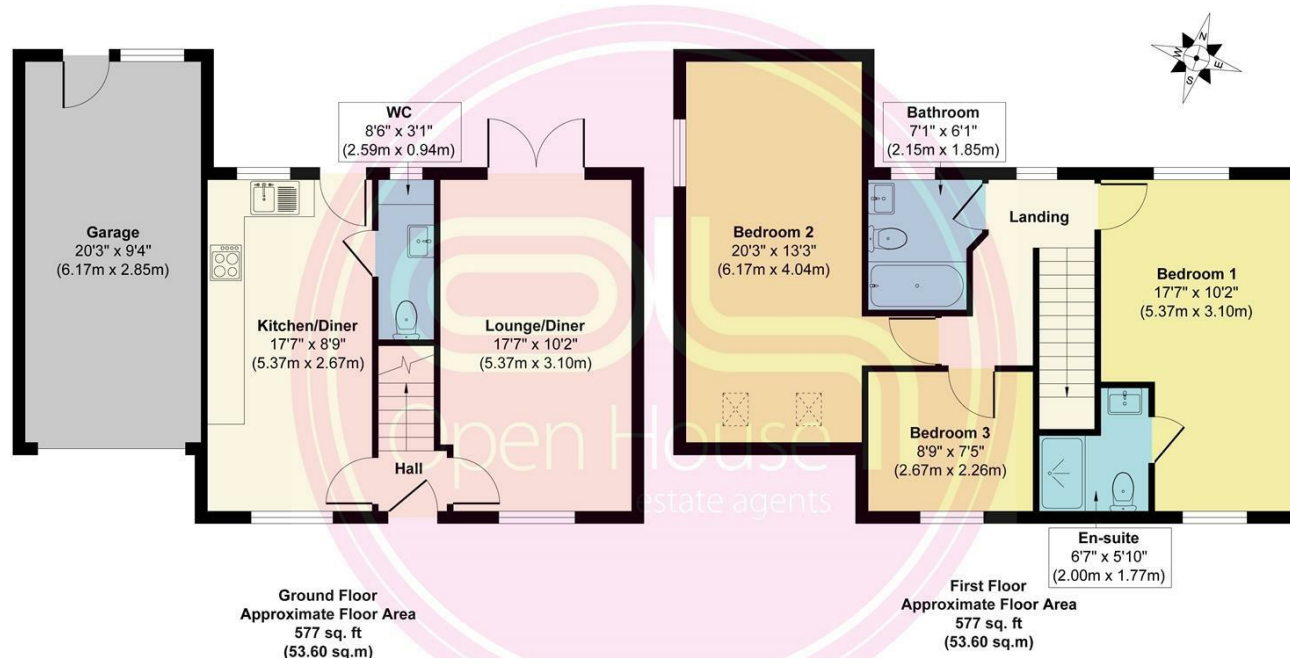

Approx. Gross Internal Floor Area 1,154 sq. ft / 107.20 sq. m (Including Garage)

Illustration for identification purposes only, measurements are approximate and not to scale, unauthorised reproduction is prohibited

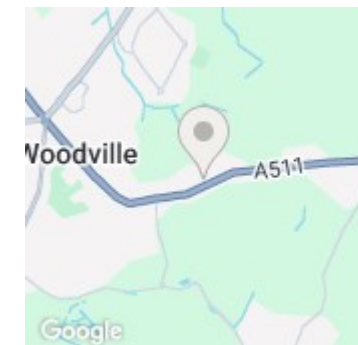

Energy Efficiency Rating		Current	Potential
Very energy efficient - lower running costs			
(92 plus)	A		93
(81-91)	B	82	
(69-80)	C		
(55-68)	D		
(39-54)	E		
(21-38)	F		
(1-20)	G		
Not energy efficient - higher running costs			
England & Wales		EU Directive 2002/91/EC	